



UNISEX BAGS
STAU760 - TOTE BAG



Woven tote bag

- Top edge double folded for strength and clean finish
- Long handles with reinforced cross stitch
- Shaping seam at bottom to create volume

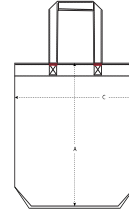

WHITES



COLORS



ESSENTIAL HEATHERS



	SIZES	OS
A	Height	39
C	Width	37
D	Strap Length	65

Printing Specifications

For suitable print techniques, please download our printing guide

Certifications & memberships



Wash Instructions

Wash similar colours together, do not iron on print, wash and iron inside out.



Shell : Canvas , 80% Recycled cotton , 20% Recycled polyester , (none) , 300 GSM